

Studio Hire

Book our beautiful studios and enjoy our amazing location and excellent customer service

Studio Hire Rates*

STUDIO	HOURLY
Ateree studio 1	¥ 3,900
Aterre studio2	Weekdays
	06:00to14:00 ¥ 2,800
	14:00to22:00 ¥ 3,300
	Weekends
	¥ 3,500

Regular Opening Hours

Weekdays from 06:00 to 22:00

Weekends from 06:00 to 22:00

Studio Booking Confirmation

Bookings can only be confirmed when payment has been received. For studio rental enquiries please email us.

Enquires will be dealt with on a first come first serve basis. For terms and conditions please click [here](#).

Contact Us

For all studio enquiries and bookings email tanaka@a-terre.com.

Studio reservations can also be made via the website.

<https://upnow.jp/aterrestudio2>



Reservation site

How to come AterreStudio



At the end of the road is Koshu Kaido.
Studio 1 is on the left.
Studio 2 is on the right.



Cross the Keio Line tracks.



Arrived at Studio 2



Exit the ticket gates at Meidaimae Station and go right.



Studio 1 is on the second floor of the building on the left.
Turn left and you will see the entrance.



AterreStudio Meidaimae1

The entrance to the building is here.
Take the elevator to the second floor.

【How to use the AterreStudio2】

Please be sure to finish using the studio at the scheduled time.
We have the next reservation.

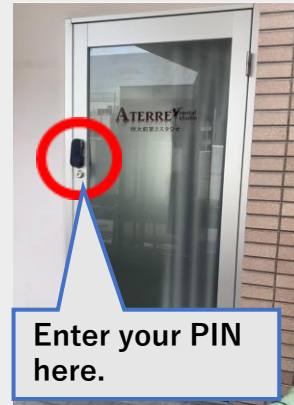

How to enter

Enter and exit through the service entrance.
The door is unlocked with a PIN code.
Please take off your shoes.

There is no need to lock the door when you leave the studio as it is an automatic locking door.



Amplifier

The volume is adjusted by the amplifier.

CD player

You can use CD, Bluetooth and AUX cord



How to use the air conditioner

Turn on the A/C.
Check the mode and change it if necessary.
Adjust the set temperature

modo

自動 : AUTO ドライ : DRY
冷房 : AC 暖房 : HEATER



Barre

The height of the barre can be adjusted

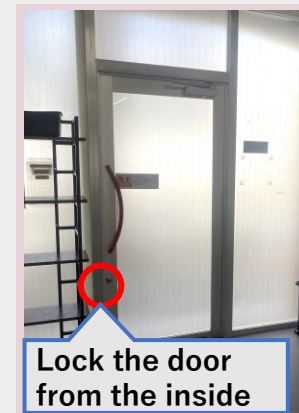

Before leaving...

Make sure the main door (the door with the red handle) is locked.

Turn off audio equipment, air conditioners, and lights.

Please take your trash home with you.

Studio2

■ If you move any equipment when using it, please return it to its original position.

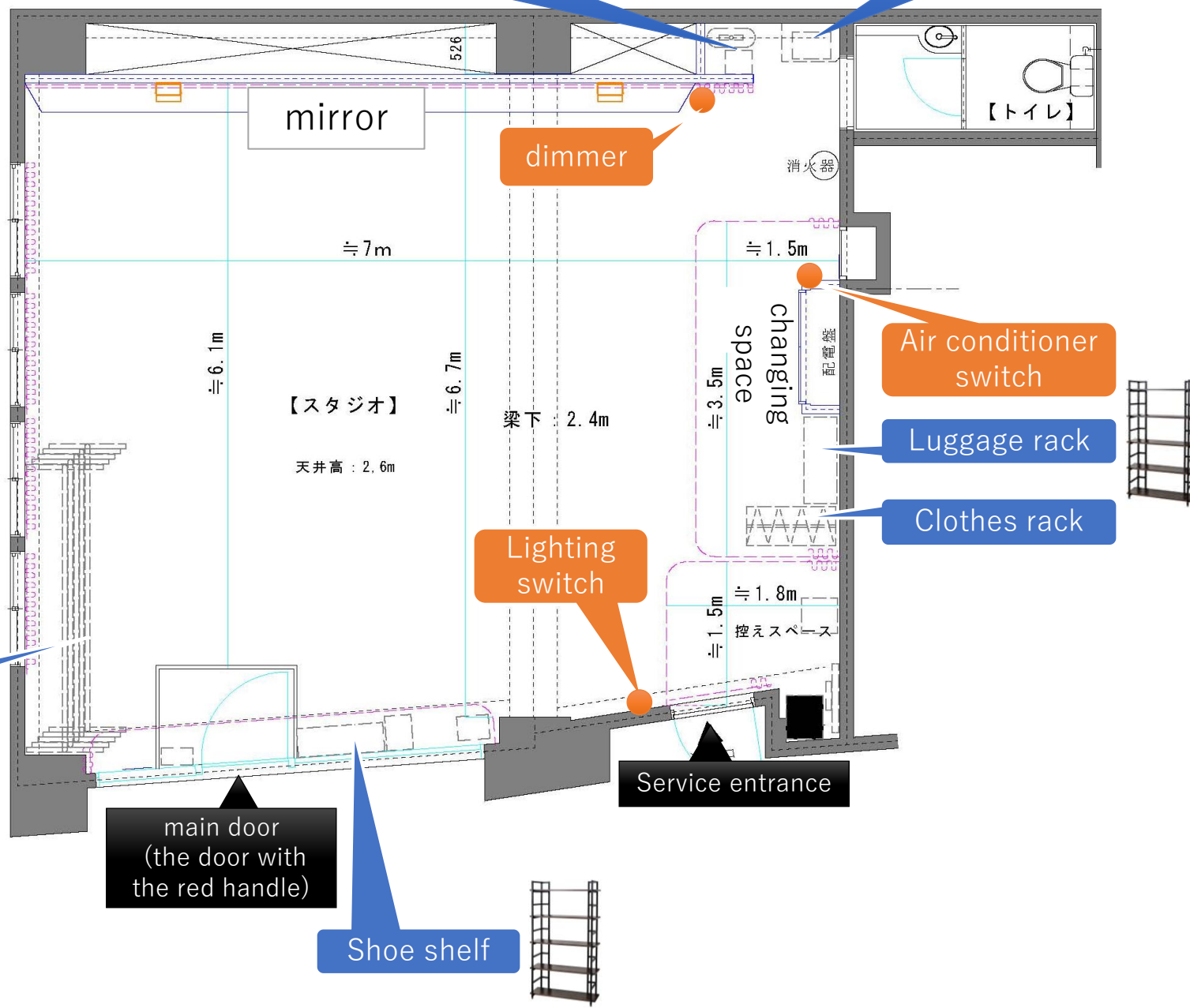

【お帰りの前に、ご確認ください】

-Please check before leaving Studio2

■ **音響機器・エアコン・除湿機**のスイッチはOFFになっておりますか？

スタジオ・トイレの**電気**も忘れずに消してください。

※除湿機はたまった水を捨ててください。

Turn off audio equipment, air conditioners, and lights.

■ **忘れ物**はございませんか？

Make sure you have everything.

■ 持ち込み品の**ごみ**はお持ち帰りください。

Please take your trash home with you.

■ メインドア（赤い取っ手のドア）の**内鍵**はかけてありますか？

※最後に出る方は、こちら側の**通用口ドア**から出てください。

オートロックになっております。

Lock the main door (the door with the red handle) from the inside.

*Exit through the service entrance on this side. It is an automatic door lock.

ドアを出る前に・・・

■ オートロックがかかっているか、**ドアを出た後に念のためご確認ください。**

Finally...

Please check from the outside that the door is locked.

【How to use the AterreStudio1】



How to enter

Take the elevator to the second floor.
The door is unlocked with a PIN code.
Please take off your shoes.



When you in the studio

If you press the "①" button when you enter the room, the door will not automatically lock even if you close it.

When you leave

When you leave, press "②" button.
It will lock automatically.
Please make sure it is locked.

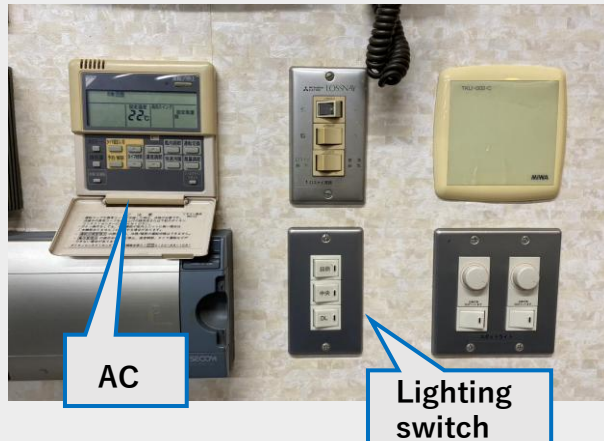

How to use the air conditioner

Turn on the A/C.

Check the mode and change it if necessary.

Adjust the set temperature

modo

自動 : AUTO ドライ : DRY
冷房 : AC 暖房 : HEATER

【How to use the AterreStudio1】

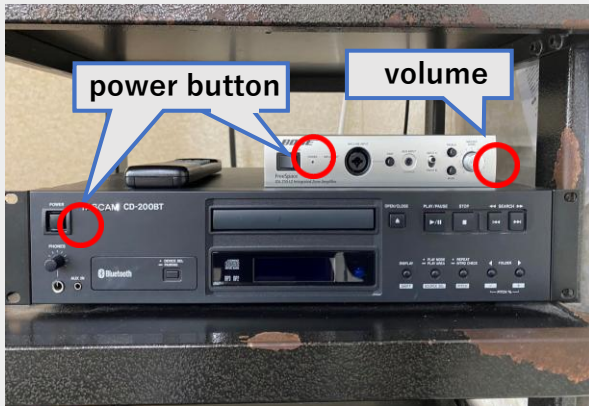

Amplifier

The volume is adjusted by the amplifier.

CD player

You can use CD, Bluetooth and AUX cord



Barre

The height of the barre can be adjusted

**Please be sure to finish using the studio at the scheduled time.
We have the next reservation.**

Before leaving...

If you move any equipment when using it, please return it to its original position.

Turn off audio equipment, air conditioners, and lights.

Please take your trash home with you.

Studio1

■ If you move any equipment when using it, please return it to its original position.

Cleaning equipment
(vacuum cleaner etc.)

Amplifier
CD player

音響

お手洗い

Changing
space

mirror

8m

エントランス

entrance

Air conditioner
switch

Lighting
switch

Barre
height adjustable

Luggage rack

Shoe shelf



【お帰りの前に、ご確認ください】

-Please check before leaving Studio1

- **音響機器・エアコン・除湿機**のスイッチはOFFになっておりますか？

スタジオ・トイレの**電気**も忘れずに消してください。

※除湿機はたまった水を捨ててください。

Turn off audio equipment, air conditioners, and lights.

- **忘れ物**はございませんか？

Make sure you have everything.

- 持ち込み品の**ごみ**はお持ち帰りください。

Please take your trash home with you.

ドアを出る前に・・・

- オートロックがかかっているか、**ドアを出た後に念のため**ご確認ください。

Finally...

Please check from the outside that the door is locked.